



26 Rose Street Wilberforce NSW

3  2  6 

Bennett Property have the pleasure of presenting this exceptional acreage estate located in the sought after suburb of Wilberforce. Situated on 5 sprawling park-like acres, this upmarket stone residence is sure to impress with exquisite original fixtures and features mixed with a modern contemporary design to create a truly magical homestead.

This majestic property is located at the end of a no through road and offers complete privacy while still being positioned close to town. The residence flaunts striking blue gum timber floors, high pressed decorative ceilings, glorious chandeliers and ceiling roses. Comprised of three well sized bedrooms, formal dining room with original fireplace, large main bathroom with claw-foot bath tub and great storage options with large linen press. The timber country style kitchen has stone bench tops and a functional skylight

Price : CONTACT AGENT
Land Size : 2 ha
View : <https://www.bennettproperty.com.au/sale/nsw/hawkesbury/wilberforce/residential/house/7940310>



Michael Bennett
02 4578 1234



Jacob Bennett
02 4578 1234

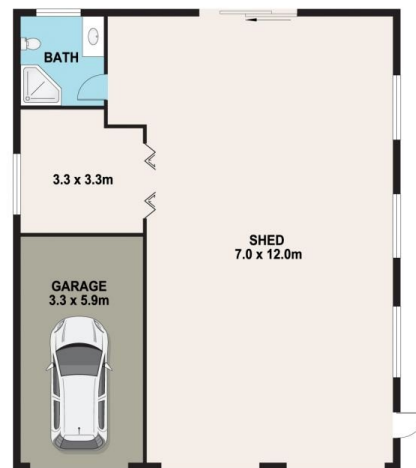
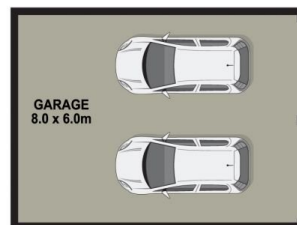

26 ROSE STREET, WILBERFORCE

DISCLAIMER

PLANS SHOWN ARE FOR MARKETING PURPOSES ONLY. ALL DIMENSIONS ARE APPROXIMATE AND NOT TO SCALE. THEY ARE SUBJECT TO ERRORS AND INACCURACIES AND NO LIABILITY WILL BE ACCEPTED. INTERESTED PARTIES SHOULD MAKE THEIR OWN ENQUIRIES.

bennettproperty