



9 Wattle Street Bowen Mountain NSW

4 2 2

Architecturally inspired custom design home, situated in one of the best positions in Bowen Mountain and designed to capture stunning views to North, East and South. Modern features and quality appointments throughout, this is the home you've been looking for!

Land Size : 659.8 sqm
View : <https://www.bennettproperty.com.au/sale/nsw/hawkesbury/bowen-mountain/residential/house/6214000>

The main level has an open plan design with soaring ceilings and Sydney Blue Gum timber floors. Large open plan kitchen with stone and laminate bench tops, Island bench, 900mm gas cooktop and walk in pantry. The open plan dining and living area flows out to a covered entertainer's deck - the perfect place to entertain or peacefully sit and enjoy the serenity. The impressive master bedroom will make every day feel like a holiday with its generous ensuite and walk-in robe. With three more large bedrooms this home offers room for the growing family. Stylish main bathroom with oversize bath and

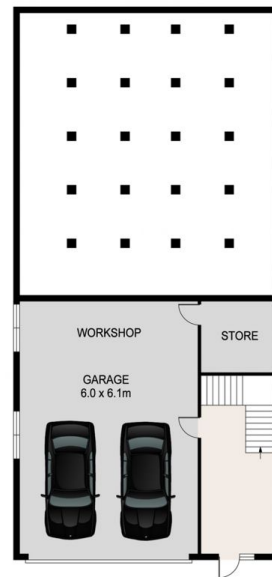

9 WATTLE STREET, BOWEN MOUNTAIN

DISCLAIMER

PLANS SHOWN ARE FOR MARKETING PURPOSES ONLY. ALL DIMENSIONS ARE APPROXIMATE AND NOT TO SCALE. THEY ARE SUBJECT TO ERRORS AND INACCURACIES AND NO LIABILITY WILL BE ACCEPTED. INTERESTED PARTIES SHOULD MAKE THEIR OWN INQUIRES.