



2/25 Neptune Crescent Bligh Park NSW

3 2 2

Newly renovated spacious brick townhouse with No Strata fees!

Open plan living living/dining area plus a separate family room with split system air-conditioning. Kitchen with gas cooking and dishwasher. All bedrooms with built-in-wardrobes, main with ensuite, ceiling fan and split system air-conditioning. Internal laundry with extra toilet and under stair storage. This home also features new carpets throughout and has been freshly painted. Undercover entertaining area with down lights, lock-up garage with internal access plus carport and fully fenced generous sized yard. Located across from park and close to local shops and schools.

Great investment or first home. NO STRATA FEES!

Land Size : 282 sqm
View : <https://www.bennettproperty.com.au/sale/nsw/hawkesbury/bligh-park/residential/house/6213914>



Jessica Tomlinson
02 4578 1234



Michael Bennett
02 4578 1234



GROUND FLOOR

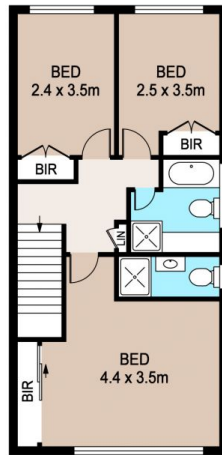

FIRST FLOOR

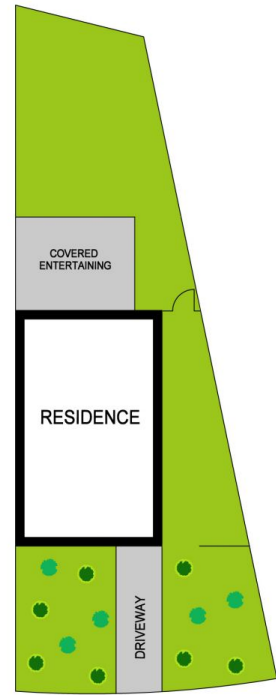

SITE PLAN

2/25 NEPTUNE CRESCENT, BLYTH PARK

DISCLAIMER

PLANS SHOWN ARE FOR MARKETING PURPOSES ONLY. ALL DIMENSIONS ARE APPROXIMATE AND NOT TO SCALE. THEY ARE SUBJECT TO ERRORS AND INACCURACIES AND NO LIABILITY WILL BE ACCEPTED. INTERESTED PARTIES SHOULD MAKE THEIR OWN INQUIRES.

