



282 Lieutenant Bowen Drive Bowen Mountain NSW

4 2 2

This fully renovated very comfortable family home offers four bedrooms, three with built in wardrobes and large upstairs loft main bedroom with new ensuite. A huge cleared level yard backing onto the Blue Mountains National Park that gives direct access walking trails.

There is plenty of space for the whole family with a formal living area and an open plan living/meals area. New kitchen with wide benches, double oven, gas cooking and massive butler's pantry.

The home features: new main bathroom, extra toilet to laundry, slow combustion fireplace, gas heater ports, ceiling fans, stylish tiled flooring, plantation shutters to all windows and is freshly painted throughout.

A private rear deck that looks over the fully fenced child and pet friendly yard. Three sheds all with power, under house storage, large water tank, enviro cycle and 3.5KW Solar System.

Price : \$ 685,000

Land Size : 1277 sqm

View : <https://www.bennettproperty.com.au/sale/nsw/hawkesbury/bowen-mountain/residential/house/6213840>



Scott Lee
0417 324 812



Maurice Mantovani
0409 121 905

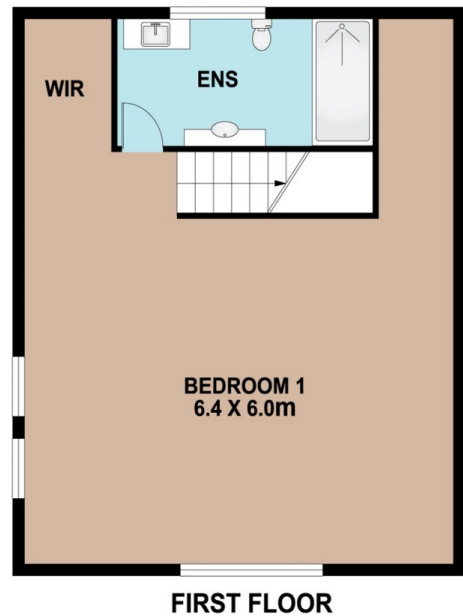

282 LIEUTENANT BOWEN DRIVE, BOWEN MOUNTAIN

DISCLAIMER

PLANS SHOWN ARE FOR MARKETING PURPOSES ONLY, ALL DIMENSIONS ARE APPROXIMATE AND NOT TO SCALE. THEY ARE SUBJECT TO ERRORS AND INACCURACIES AND NO LIABILITY WILL BE ACCEPTED. INTERESTED PARTIES SHOULD MAKE THEIR OWN INQUIRIES.